



**ESCENT**  
PHUKET

BROUGHT TO YOU BY  
**CENTRALPATTANA**

# CREATIVE CONNECTIVE LIVING

---

“

เชื่อมต่อความสุข  
เต็มเต็มทุกไลฟ์สไตล์

”



This image only for advertising purpose.

\*COMPU

## PROJECT INFORMATION

<b>Project Name:</b>	Escent Phuket
<b>Owner:</b>	Central Pattana Residence Co., Ltd.
<b>Location:</b>	Muang Naka Rd, Wichit, Mueang Phuket District, Phuket 83000
<b>Land Areas:</b>	6-1-90 Rais
<b>Project Type:</b>	Low Rise Building 8 Storeys, 3 Building, Facilities Building 2 Storeys, Total 513 Units
<b>Unitsroom Type:</b>	Fully Furnished
<b>Parking:</b>	33% (174 Parking Lots)

## FACILITIES

Salt Water Lap Pool  
Kid's Pool  
Jacuzzi  
Co-Working & Meeting Lounge  
The Beach Pavilion  
Fitness  
Community Garden

## UNIT TYPE

<b>1 Bedroom</b>	25 Sq.m.
<b>1 Bedroom</b>	28 Sq.m.
<b>2 Bedroom</b>	51 Sq.m.

## SMART SECURITIES

### DOUBLE GATE ENTRANCE

Elevate your security with a double gate entrance with a height of 2.5 meters.

### LICENSE PLATE RECOGNITION

Artificial Intelligence for recognizing owner's license plate upon entering the property.

### VISITOR MANAGEMENT SYSTEM

Scan QR code for your visitor's convenience.

### FACE SCAN

Enter the lobby with Face Scan for owners.

### FACE SCAN (LOCK FLOOR)

Security of the highest level with our touchless lock floor system.

### CCTV & 24 HRS. SECURITY GUARD

Security cameras situated on more than 223 locations with 24 hours security guards.

### DIGITAL DOOR LOCK

Feel safer with automatic lock door complete with passcode finger scan, key, bluetooth and card for a secure, fast and convenient life.

This image only for advertising purpose.



SALT WATER POOL

This image only for advertising purpose.



THE BEACH PAVILION

## KEY PLAN



## Building A Building B Building C

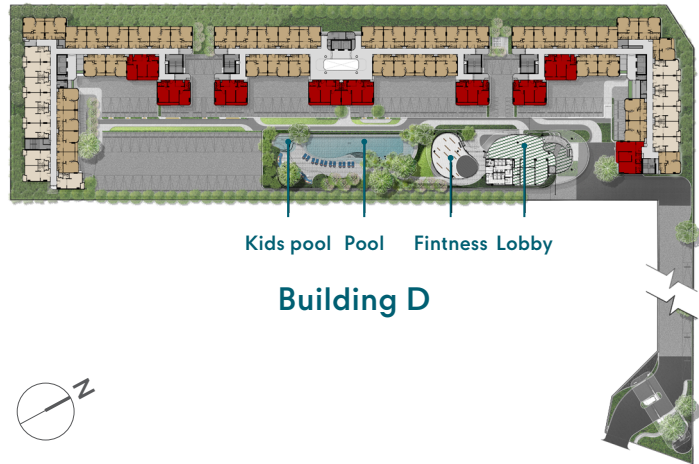

## 1 BEDROOM

25 sq.m.



This image only for advertising purpose.



## 1 BEDROOM

28 sq.m.



This image only for advertising purpose.



## 2 BEDROOM

51 sq.m.



This image only for advertising purpose.

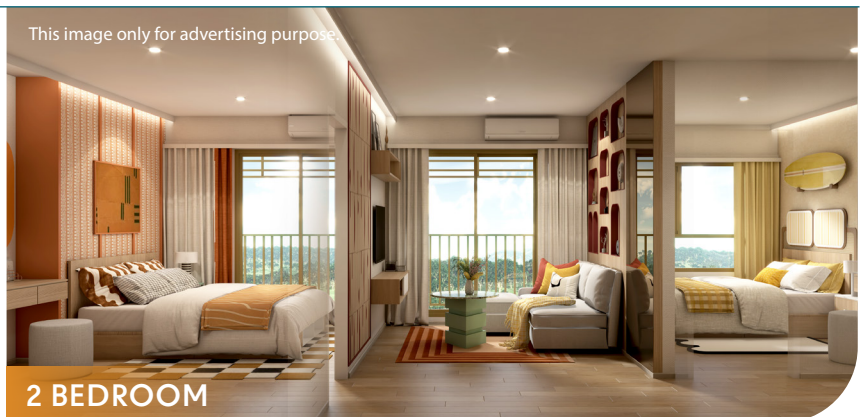

CENTRAL CITIZENS  
Reserved Parking

CENTRAL CITIZENS  
Special Top Up Value

CENTRAL CITIZENS  
Exclusive Lounge



เพิ่มเวลาความสุขของทุกการช้อปปิ้ง  
ด้วย**บริการช่องจอดรถพิเศษเฉพาะลูกบ้าน**  
ในศูนย์การค้าเซ็นทรัล (\*เฉพาะบางสาขา)

BROUGHT TO YOU BY  
CENTRALPATTANA

ทุกการเติมเงินใน Central Food Park  
สำหรับทานอาหารและเครื่องดื่ม  
**Top Up 10%\*ทันที** (จากยอดเดิม)

BROUGHT TO YOU BY  
CENTRALPATTANA

ลูกบ้านใช้บริการ Lounge ที่ Sale Gallery\*  
**FREE !! เครื่องดื่ม ของทานเล่น และ WIFI**  
(\*ESCENT CONDO และ PHYLL PHUKET)

BROUGHT TO YOU BY  
CENTRALPATTANA

# CENTRAL CITIZENS

ลูกบ้านเซ็นทรัลพัฒนา เรชซิเดนซ์

รับสิทธิประโยชน์ที่มากกว่า

ส่วนลด บริการ และสิทธิพิเศษ

จากแบรนด์ในเครือเซ็นทรัล กรุ๊ป



\*ภาพถ่ายเพื่อการโฆษณาเท่านั้น | \*เงื่อนไขเป็นไปตามที่บริษัทฯ กำหนด

# ESCENT PHUKET

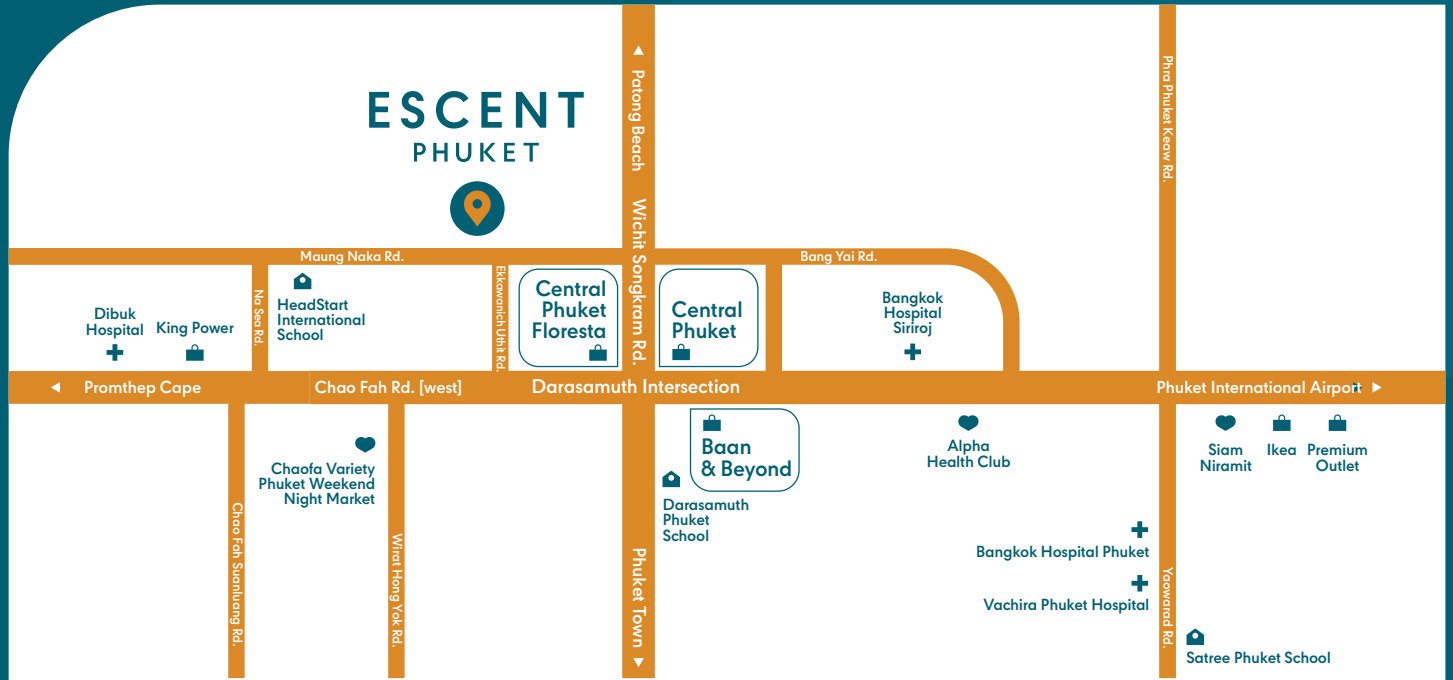

## Shopping Mall

Central Phuket Floresta	0.3 km.
Central Phuket	0.8 km.
Baan & Beyond	2.1 km.
King Power Phuket	3.5 km.
Premium Outlet	7.4 km.
IKEA	8.5 km.

## School

HeadStart International School	0.55 km.
Darasamuth Phuket School	0.85 km.
Satree Phuket School	3.4 km.

## Hospital

Bangkok Hospital Siriroj	1.4 km.
Dibuk Hospital	3.3 km.
Bangkok Hospital Phuket	3.4 km.
Vachira Phuket Hospital	3.4 km.

## Neighborhood

Chaofa Variety Phuket Weekend Night Market	2.1 km.
Alpha Health Club	2.6 km.
Siam Niramit	6.4 km.

02 021 9999  
residence.centralpattana.co.th



The project owner, Central Pattana Residence Company Limited (the "Company") with company registration number 0105550131420, has its headquarters located at 999/9 Rama 1 Road, Pathum Wan Sub-district, Pathum Wan District, Bangkok. The Company's registered capital is 1,000,000,000.00 Baht, with paid-up capital of 400,600,000 Baht. The authorized signatories are Miss Wallaya Chirathivat and Flt.Lt. Kree Dejchai. The project, named Escent Phuket (the "Project"), is situated on Moo 5, P.K. 4050 Rural Road, Wichit District, Mueang Phuket District, Phuket Province, with land title deed number 119177 and 119181, land number 601 and 50, Wichit District, Mueang Phuket District, Phuket Province, with an approximate area of 6-1-90 Rai. The Project's land has servitude (partially) for walkways, car roads, electricity, water supply, telephone, and drainage pipes, including various public utilities both above and below ground, on land title deed number 119180, land number 604, in the same sub-district and district. The land is free of encumbrances. The Project's format is a residential building, 8 floors high, comprising 3 buildings and 2 floors high, comprising 1 building, with 514 residential units. The Company has been granted permission to construct the building under construction permit number 024/2565 issued on 2nd March 2022. Construction is expected to commence around December 2024 and is estimated to be completed around August 2026. Upon completion of construction, it will be registered as a condominium, and buyers must pay the fund, common expenses, taxes, and fees as stipulated by the Project owner or legal entities under condominium laws. All images are simulated and for illustrative purposes. The Company reserves the right to change details, prices, and interior decorations as deemed appropriate without prior notice.